

# Window & Roof Tensioned Pleated Blind

## Fitting, operation and maintenance instructions

**Warning!** The operating instructions must be read before operating the blind.

### Fitting Instructions for Window Tensioned Pleated Blinds | Top-fix Installation

This procedure can be completed by non-professionals.

#### Step 1 - Identify and position the brackets

Ensure that each supplied bracket is positioned at least 50 mm from each end of the blind, with any remaining brackets spaced no more than 500 mm apart.

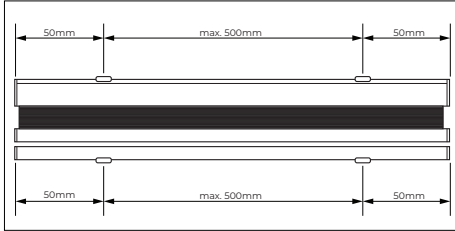

#### Step 2 - Mark, drill, and secure the brackets

If necessary, mark the screw positions by pencil through the bracket slots. Drill and plug the holes as required, then fix the brackets securely using appropriate fittings.

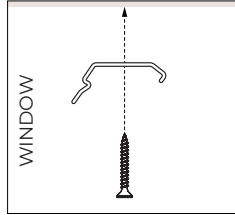

Top brackets

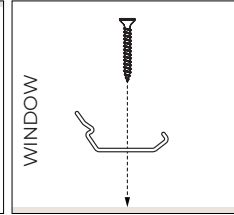

Bottom brackets

#### Step 3 - Install the blind

Once the brackets are securely fixed, remove the blind from its packaging and carefully clip it into the brackets, ensuring that it is firmly secured in place.

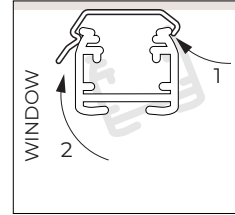

Headrail installation

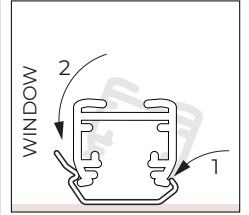

Bottom rail installation

### Fitting Instructions for Window and Roof Tensioned Pleated Blinds | Face-fix Installation

This procedure can be completed by non-professionals.

#### Step 1 - Identify and position the brackets

Ensure that each supplied bracket is positioned at least 50 mm from each end of the blind, with any remaining brackets spaced no more than 500 mm apart.

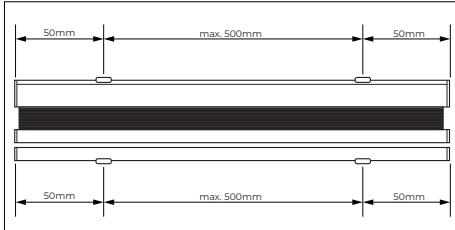

#### Step 2 - Mark, drill, and secure the brackets

If necessary, mark the screw positions by pencil through the bracket slots. Drill and plug the holes as required, then fix the brackets securely using appropriate fittings.

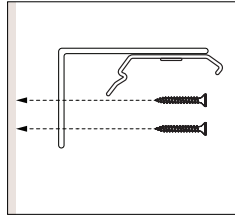

Top brackets

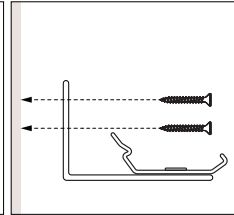

Bottom brackets

#### Step 3 - Install the blind

Once the brackets are securely fixed, remove the blind from its packaging and carefully clip it into the brackets, ensuring that it is firmly secured in place.

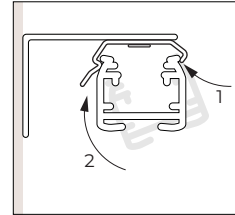

Headrail installation

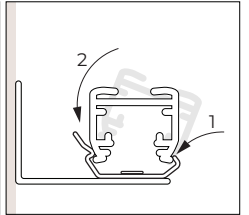

Bottom rail installation

### Fitting Instructions for Window Tensioned Pleated Blinds with Bottom Feet | Top-fix Installation

This procedure can be completed by non-professionals.

#### Step 1 - Identify and position the brackets

Ensure that each supplied bracket is positioned at least 50 mm from each end of the blind, with any remaining brackets spaced no more than 500 mm apart.

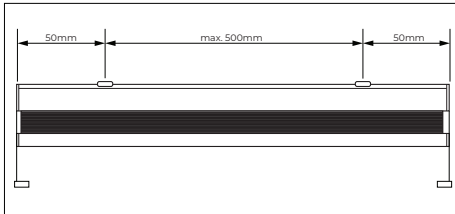

#### Step 2 - Mark, drill, and secure the brackets

If necessary, mark the screw positions by pencil through the bracket slots. Drill and plug the holes as required, then fix the brackets securely using appropriate fittings.

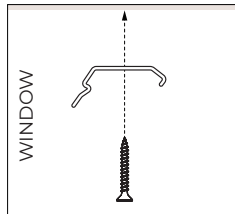

#### Step 3 - Install the blind

Once the brackets are securely fixed, remove the blind from its packaging and carefully clip it into the brackets, ensuring that it is firmly secured in place.

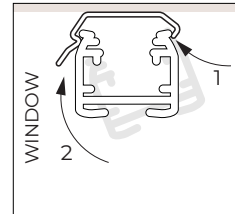

#### Step 4 - Secure the Tensioning Cord Feet

Screw the tensioning cord feet attachment to the window cill on both sides, ensuring they are aligned with the blind edges for smooth operation.

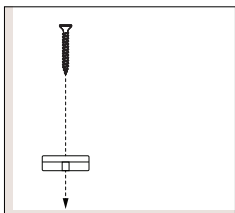

#### Step 5 - Attach the Cord Tensioning Feet

Secure the cord tensioning feet on either side by sliding them onto the attachment, then adjust the cord tension to ensure smooth operation.

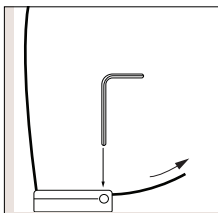
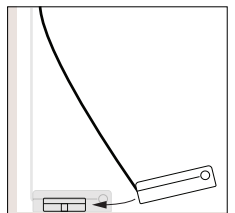

## Fitting Instructions for Multi-zone Pleated Blinds

This procedure can be completed by non-professionals.

### Step 1 - Align and Position the Cord Feet

It is absolutely critical for the cord feet to be positioned precisely in line with the outer edges of the blind and perfectly level with the plane of the blind fabric. Accurate alignment at this stage is essential to guarantee smooth and balanced operation.

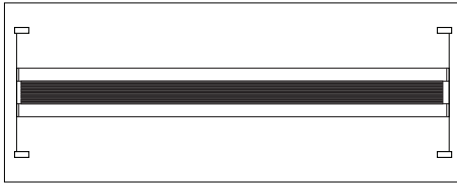

### Step 2 - Secure the cord feet attachment

Screw the Tensioning Cord Feet Attachment to the top and bottom of the recess on both sides, ensuring they are aligned with the blind edges for smooth operation.

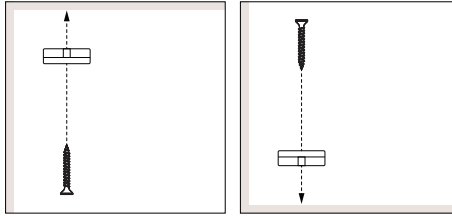

### Step 3 - Install the blind

Secure both the top and bottom cord tensioning feet by carefully sliding them onto the pre-installed attachments on either side of the blind.

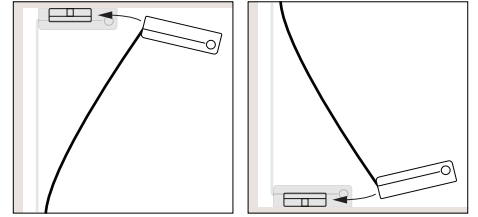

### Step 4 - Adjust the cord tension

Fine-tune the cord tension using the bottom cord tensioning feet to achieve smooth and controlled movement of the blind. Ensure the cords are evenly tensioned on both sides.

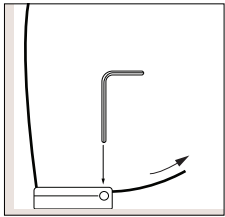

## Operation & Maintenance

**Warning!** The operating instructions must be read before operating the blind.

### Operating instructions for manual Window Tensioned and Multi-zone Pleated Blinds

Use the bottom bar operating handle to move the blind to the desired position. Pull the handle downward to close the blind or push it upward to open it. Blinds installed at height are operated by an operating rod. Pull the handle downward with an operating rod to close the blind or push it upward to open it.

### Operating instructions for motorised Window and Roof Tensioned Pleated Blinds

Use the supplied control device to operate the blind electronically. For detailed information on operating modes, please refer to the Motorisation Instructions supplied with this blind before use.

### Maintenance Instructions

This product is designed to be maintenance-free; however, we recommend carrying out regular visual inspections to ensure that no components are damaged, as this could lead to operating difficulties or pose a safety risk. If any maintenance is required, it should be completed promptly by a reputable blind company.